

# SCAB BRACE DETAIL - SINGLE PLY TRUSSES

B37019P

The scab brace detail can be used as an alternative method of bracing compression webs of single ply trusses. Where the original design calls for lateral bracing on a web, the scab brace is an acceptable alternative provided that the maximum factored axial force in the web member does not exceed the values in this detail.

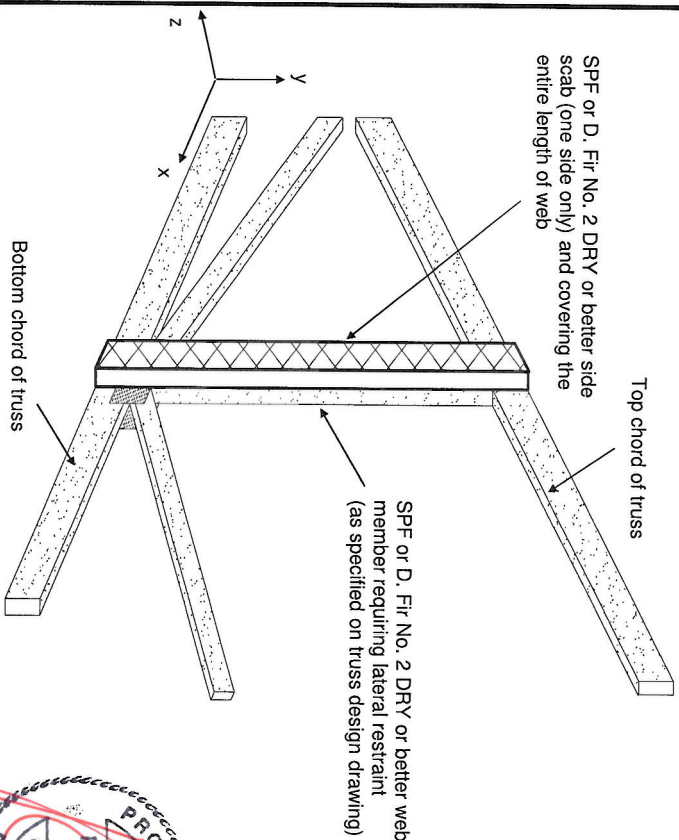

- NOTES:
- Scab size must be equal to web size (i.e. use a 2x4 scab brace on a 2x4 web, etc.)
  - Scab brace and web lumber must be DRY at time of fastener installation
  - Scab brace must cover the entire length of web
  - Web Lumber to be SPF or D, Fir species, and No. 2 or better grade
  - Scab brace lumber may be either SPF or D, Fir species and No.2 or better grade
  - This detail is valid only for web lengths ranging from 5 ft. to 12.5 ft.
  - This detail CANNOT be used to repair damaged webs.
  - Tabulated resistance values are for "Standard" load duration only ( $K_D=1.0$ )
  - This detail is to be used in conjunction with sealed MITtek Canada drawings only
  - This detail is not valid after April 30, 2013

## MAXIMUM FACTORED WEB FORCE FOR SCAB BRACE DETAIL (LB)

WEB LENGTH ( FT )	WEB SIZE				
	2x3	2x4	2x5	2x6	2x8
5.00	4264	5969	7674	9380	12364
5.50	3827	5358	6889	8420	11098
6.00	3409	4772	6135	7499	9885
6.50	3019	4226	5433	6641	8754
7.00	2663	3728	4794	5859	7723
7.50	2345	3283	4221	5158	6800
8.00	2063	2888	3713	4538	5982
8.50	1812	2537	3262	3987	5255
9.00	1594	2232	2870	3507	4623
9.50	1406	1968	2530	3093	4077
10.00	1243	1740	2237	2734	3604
10.50	1102	1543	1983	2424	3195
11.00	980	1372	1764	2156	2841
11.50	874	1223	1573	1923	2534
12.00	782	1095	1407	1720	2267
12.50	701	982	1263	1543	2034

For intermediate web lengths, do not interpolate. Use the tabulated value of the next longest web.

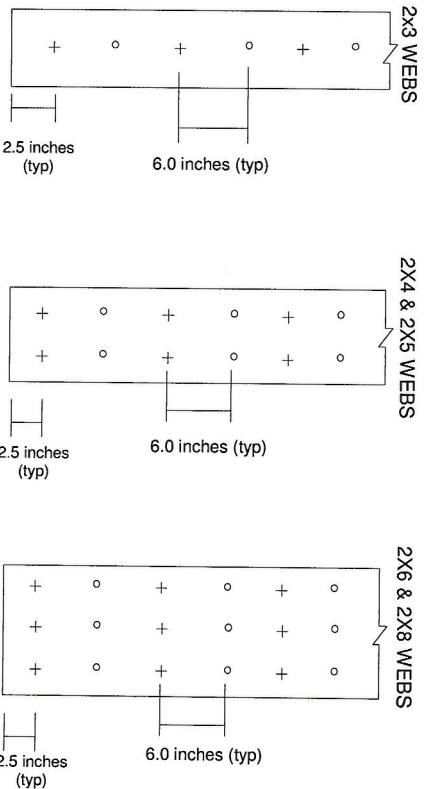
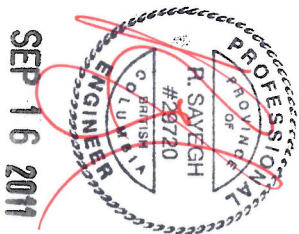

### NAILING PATTERN FOR SCAB BRACE

- + 3.0 inch COMMON SPIRAL NAIL DRIVEN FROM FRONT FACE
  - o 3.0 inch COMMON SPIRAL NAIL DRIVEN FROM BACK FACE
- Fit in maximum number of nails into scab, while respecting the nailing patterns shown above.



MITtek Canada Inc  
100 Industrial Rd.  
Bradford, Ontario L3Z 3G7